

Stockport Exchange – Phase 2

Site Newsletter No. 2 : September 2015

Contract Overview

Eric Wright Construction are the contractors chosen by Muse Developments to deliver Phase 2 of Stockport Exchange with minimal disruption.

Phase 2 development will see the construction of a 50,000 sq ft Grade A office building with retail at ground floor and a 115 bed hotel opposite Stockport train station.

This will be complemented by extensive public realm works providing an attractive green oasis in an urban environment.

Key Dates

Start on Site:
August 2015

Building Works Complete:
Autumn 2016



How will this work impact me?

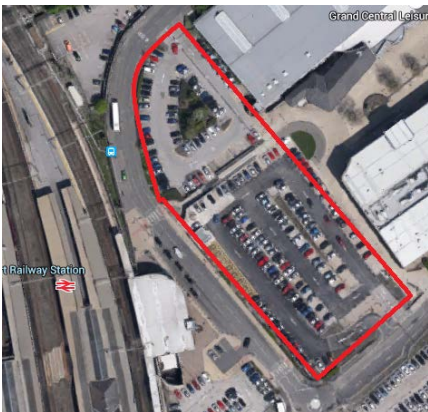
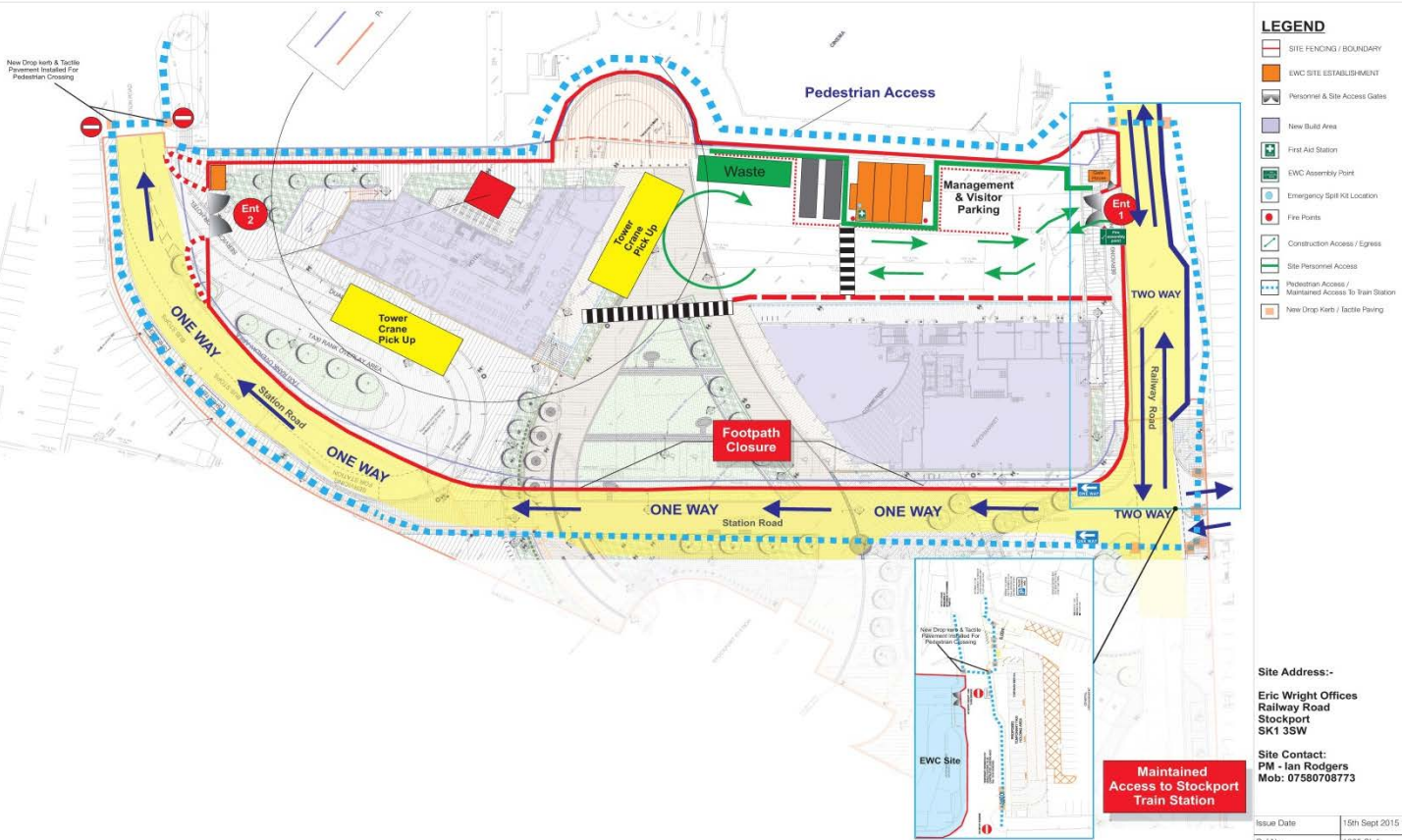

August 2015 - January 2016

During the first stage of the project a footpath closure will be in place to the perimeter of the site boundary. Safety is important to us so to allow safe access we have created safe pedestrian crossing points. These have been put in place to allow pedestrian access from the A6 to and from Stockport train station via Railway Road or Station Road. New taxi feeder lanes have been constructed on Railway Road which will be in use from the first week in October. From the first week of October a new one way traffic system will also be in place that will be clearly signed. Details of the changes are shown on the plan above. The pedestrian access way at the side of Life Leisure will alter slightly in position on Tuesday 22nd September to a new illuminated, CCTV covered passageway.

Other works taking place in September and October 2015

From the 21st September 2015 piling foundation work will begin along with drainage and foundation works. All of these works will be within the construction site boundary.

How will this work impact me?

Stockport Exchange

Stage 1b

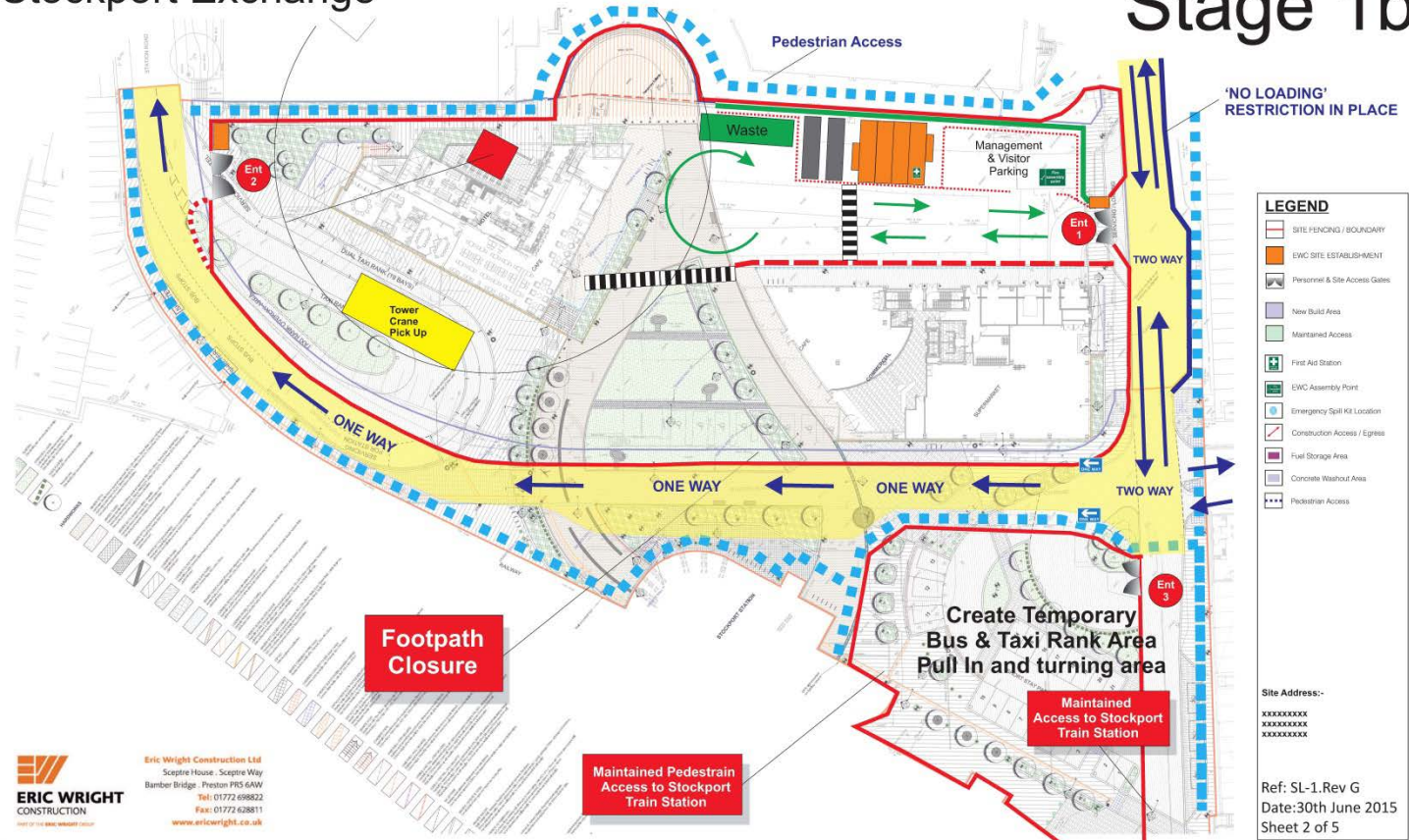

ERIC WRIGHT CONSTRUCTION
Eric Wright Construction Ltd
Sceptre House, Sceptre Way
Bamber Bridge, Preston PR3 6AW
Tel: 01772 098822
Fax: 01772 628811
www.ericwright.co.uk



January – March 2016

During this stage of works there will be a 4 week period during which a temporary taxi rank and pull in / turning area will be created before the public realm works can be started. The road will remain open throughout this time.

Pedestrians, users of the station and stakeholders will remain informed about changes taking place in the area, and kept safe via signage and segregation from the site traffic.

How will this work impact me?

Stockport Exchange

Stage 2a

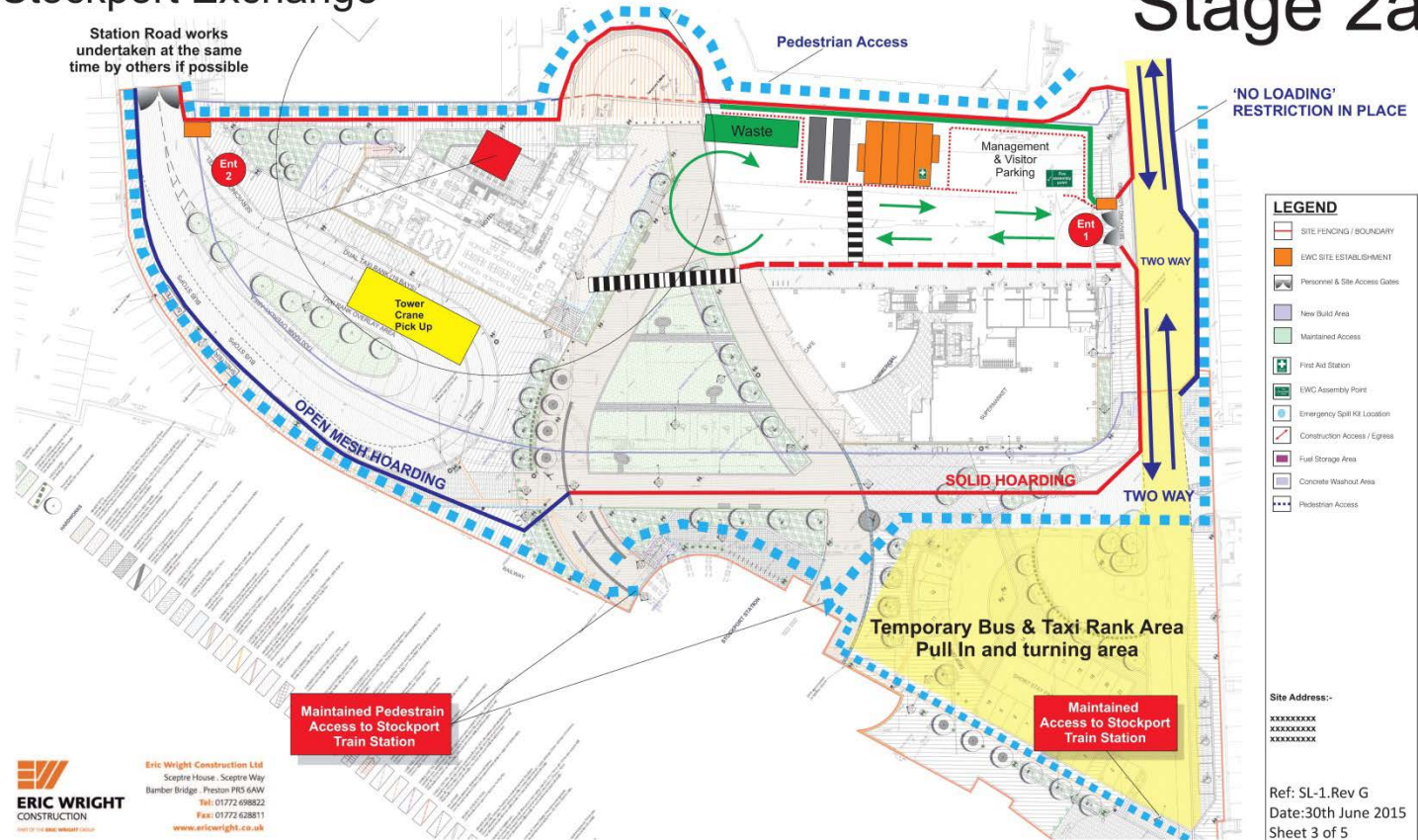

ERIC WRIGHT CONSTRUCTION
 Eric Wright Construction Ltd
 Sceptre House, Sceptre Way
 Bamber Bridge, Preston PR3 6AW
 Tel: 01772 098822
 Fax: 01772 628811
 www.ericwright.co.uk



February - July 2016

At this stage, Station Road will close to vehicles whilst the public realm works are completed.

Vehicular access to and from the railway station will be via Railway Road. Large directional signage will be prominent and kept in good condition.

The pedestrian passageway will be well lit and monitored by CCTV.

How will this work impact me?

Stockport Exchange

Stage 2b

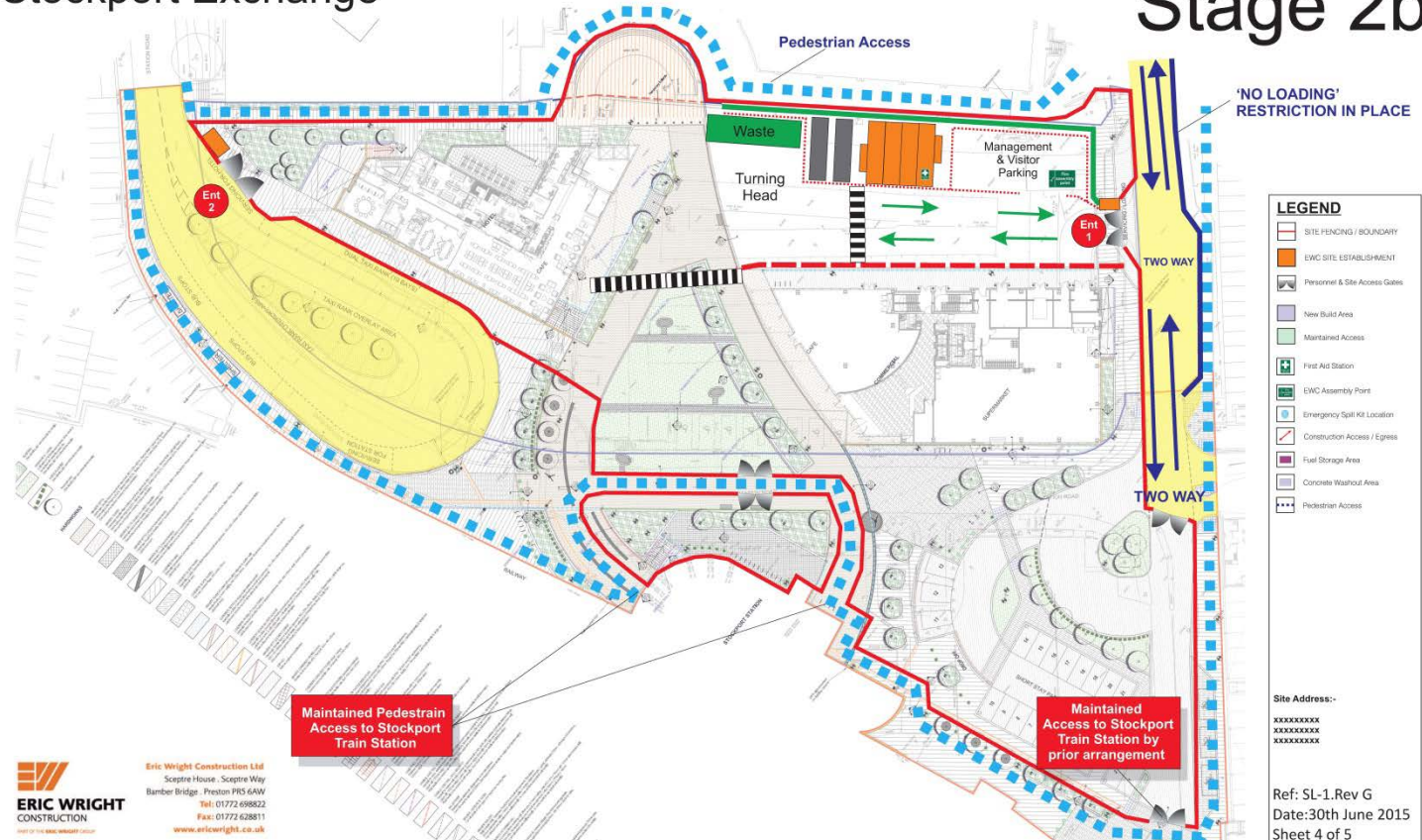

ERIC WRIGHT CONSTRUCTION
Eric Wright Construction Ltd
Sceptre House, Sceptre Way
Bamber Bridge, Preston PR5 6AW
Tel: 01772 698822
Fax: 01772 628811
www.ericwright.co.uk

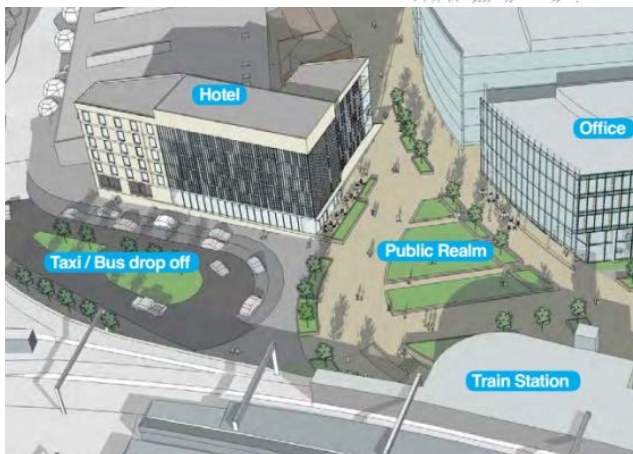

July - Autumn 2016

Access to the new taxi rank will be available at this stage.

Public realm works will be ongoing and therefore for safety pedestrians will still be directed around the hoarding and away from any traffic.

How will this work impact me?

Stockport Exchange

Stage 2c

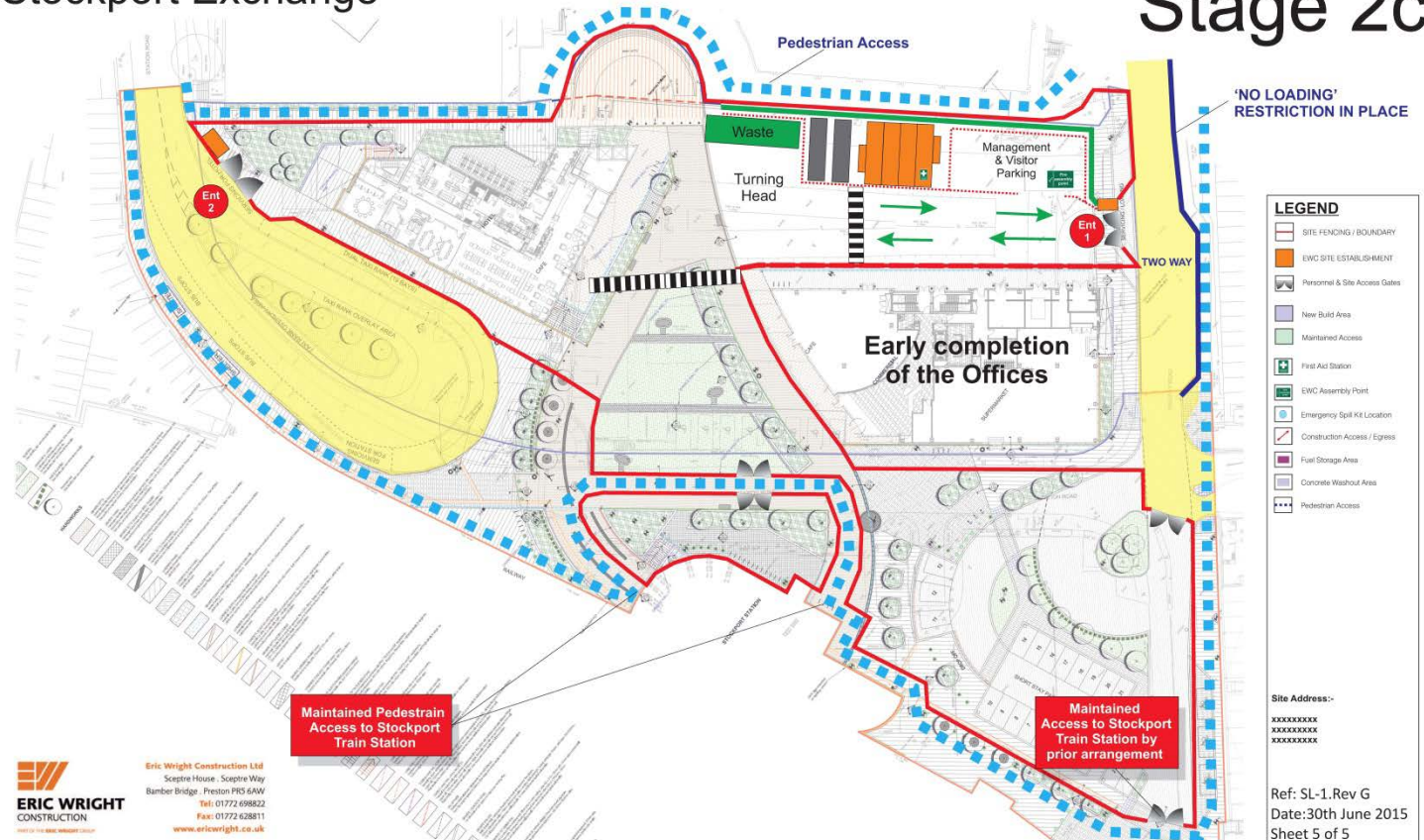

Phase 5 - Autumn 2016

At this time it is planned that the office and retail unit will be opened. The public realm works will also be partially open for access at this stage, alongside a short stay car park.

By the end of Autumn 2016 all works will have been completed.



Code of Considerate Practice

As associate members of the Considerate Constructors scheme we are committed to ensuring our sites comply with the following:

- ✓ **Care about** Appearance
Constructors should ensure sites appear professional and well managed
- ✓ **Respect the** Community
Constructors should give utmost consideration to their impact on neighbours and the public
- ✓ **Protect the** Environment
Constructors should protect and enhance the environment
- ✓ **Secure Everyone's** Safety
Constructors should attain the highest levels of safety performance
- ✓ **Value their** Workforce
Constructors should provide a supportive and caring working environment



Working in Stockport

Eric Wright Construction have committed to using local labour and materials where possible while undertaking these works. We will be working with your local job centre to advertise any vacancies.

Site Contact Details



Any feedback, suggestions or requests can be directed to our project manager **Ian Rodgers**. Our site offices are located off Station Road. Ian is based on site permanently throughout the works.

T: 07580 708773
E: irodgers@ericwright.co.uk

For more information on Eric Wright Construction please visit:
www.ericwright.co.uk



Please follow us on:

